

F07 Miniature general purpose filters

- Port size: G1/8 & G1/4
- Direct ported filters with high water removal efficiency
- Very compact unit



Technical features

Medium:
Compressed air only

Maximum inlet pressure:
10 bar (145 psi) Transparent bowl
17 bar (246 psi) Metal bowl

Filter element:
5 or 40 µm

Typical flow:
see below

Port sizes:
G1/8 or G1/4



Bowl volume:
31 ml

Drain: Manual or automatic

Ambient/Media temperature:
Transparent bowl
-34 ... +50°C (-29 ... +122°F)
Metal bowl
-34 ... +80°C (-29 ... +176°F)
Air supply must be dry enough to avoid ice formation at temperatures below +2°C (+35°F)

Materials:
Body: Zinc alloy
Bowl: Plastic or Zinc alloy
Filter element: Sintered PP
Elastomers: NBR

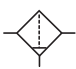
Technical data, standard model

Symbol	Port size	Filter element (µm)	Flow *1) (dm³/s)	Drain	Bowl	Weight (kg)	Model
	G1/8	40	9	Manual	Plastic	0,13	F07-100-M3TG
	G1/4	40	11,5	Manual	Plastic	0,13	F07-200-M3TG
	G1/8	40	9	Automatic	Plastic	0,13	F07-100-A3TG
	G1/4	40	11,5	Automatic	Plastic	0,13	F07-200-A3TG

*1) Typical flow with 6,3 bar (91 psi) inlet pressure and a 0,3 bar (4,3 psi) droop from set.

Option selector

F07-★00-★★★★			
Port size	Substitute	Thread form	Substitute
1/8"	1	PTF	A
1/4"	2	ISO G	G
Drain	Substitute	Bowl	Substitute
Automatic	A	Plastic	T
Manual	M	Metal	M
		Filter element	Substitute
		5 µm	1
		40 µm	3

Flow characteristics Port size 1/4", filter element 40 µm

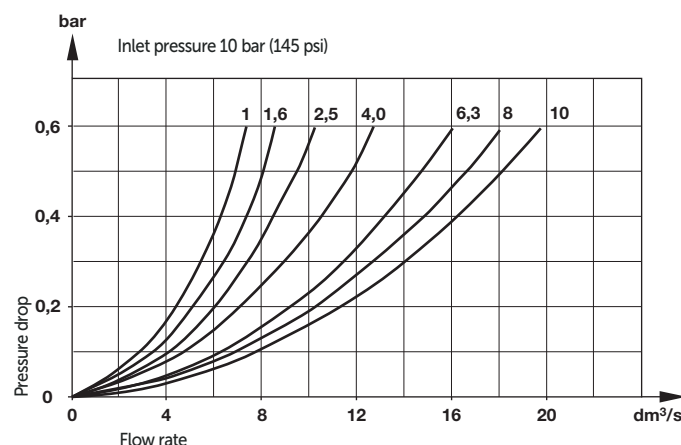

Accessories and service kit



Dimensions

Manual drain

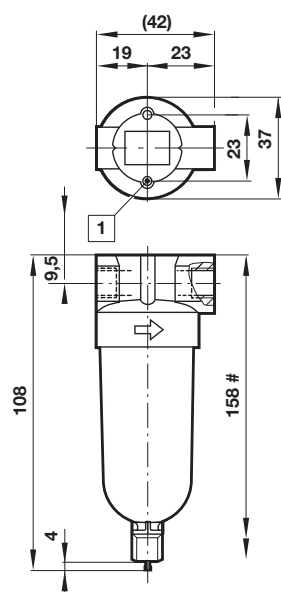

Automatic drain

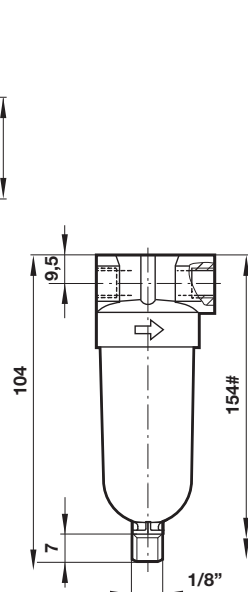

Minimum clearance required to remove bowl
 1 Mounting holes, \varnothing 4 mm, 13 mm deep

Warning

These products are intended for use in industrial compressed air systems only. Do not use these products where pressures and temperatures can exceed those listed under »**Technical features/ data**«.

Before using these products with fluids other than those specified, for non-industrial applications, life-support systems or other applications not within published specifications, consult Norgren Ltd.

Through misuse, age, or malfunction, components used in fluid power systems can fail in various modes.

Service kit

	Service kit manual drain	Service kit automatic drain
5 μ m:	F07-KITM05 (5 μ m – black)	F07-KITA05 (5 μ m – black)
40 μ m:	F07-KITM40 (40 μ m – green)	F07-KITA40 (40 μ m – green)

Wall mounting bracket

Dimensions in mm
 Projection/First angle

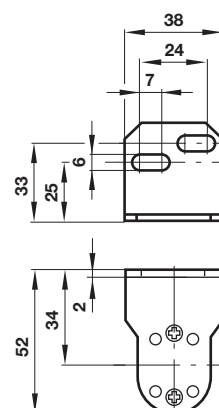

Use 1/8" (3 mm) screws
 to mount bracket to wall.